

Welcome to Roku

This guide contains all the information you need to get set up quickly from the comfort of your couch.

What's included in the box

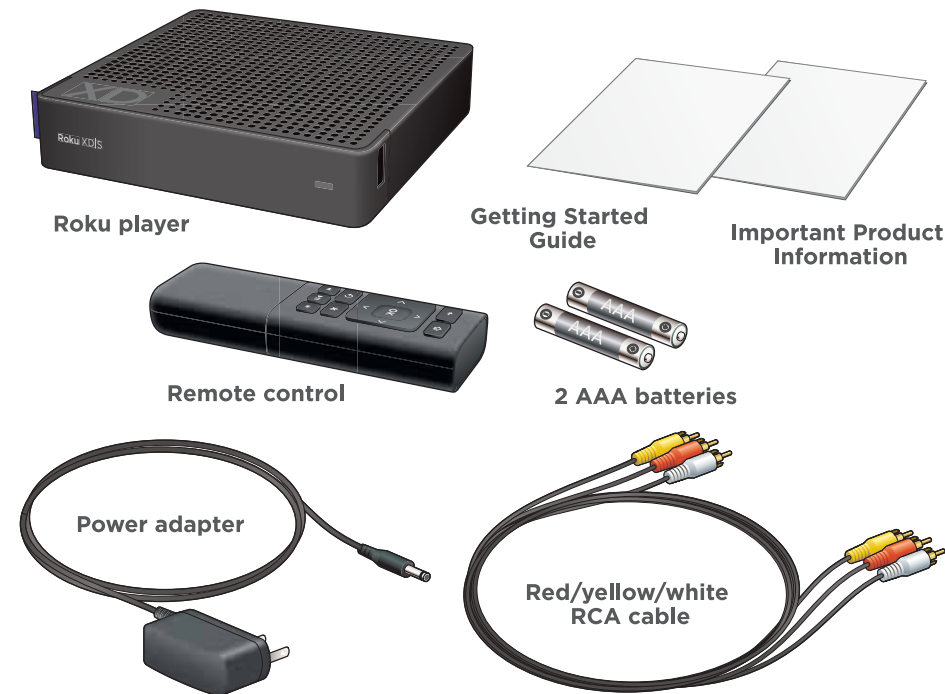

What you need to use your player

- A TV (high-definition or standard-definition)
- One of the following sets of cables:
 - Red/yellow/white RCA cable (included)
 - HDMI cable*
 - Component to 3.5mm video cable**, plus either a red/yellow/white RCA cable or a digital optical audio cable*
- A broadband Internet connection (DSL, cable, LAN) — the faster your connection, the better the quality.
- A wireless network, or a wired network using an Ethernet cable (not included).

* sold separately
** sold separately only at www.roku.com

Your Roku player at a glance

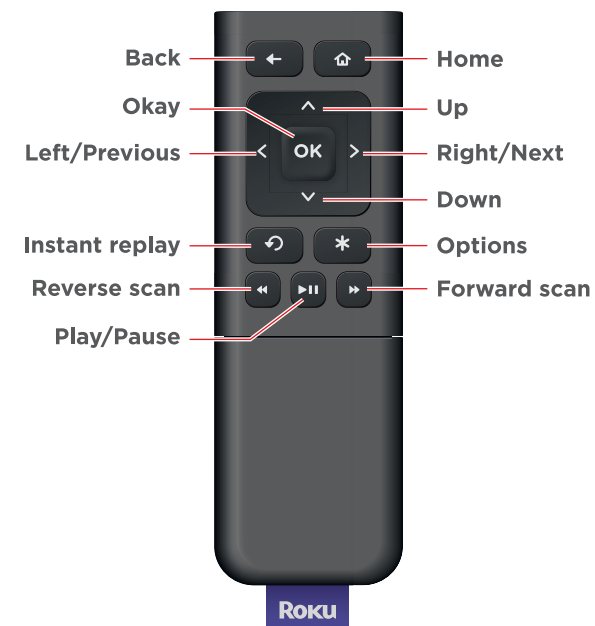
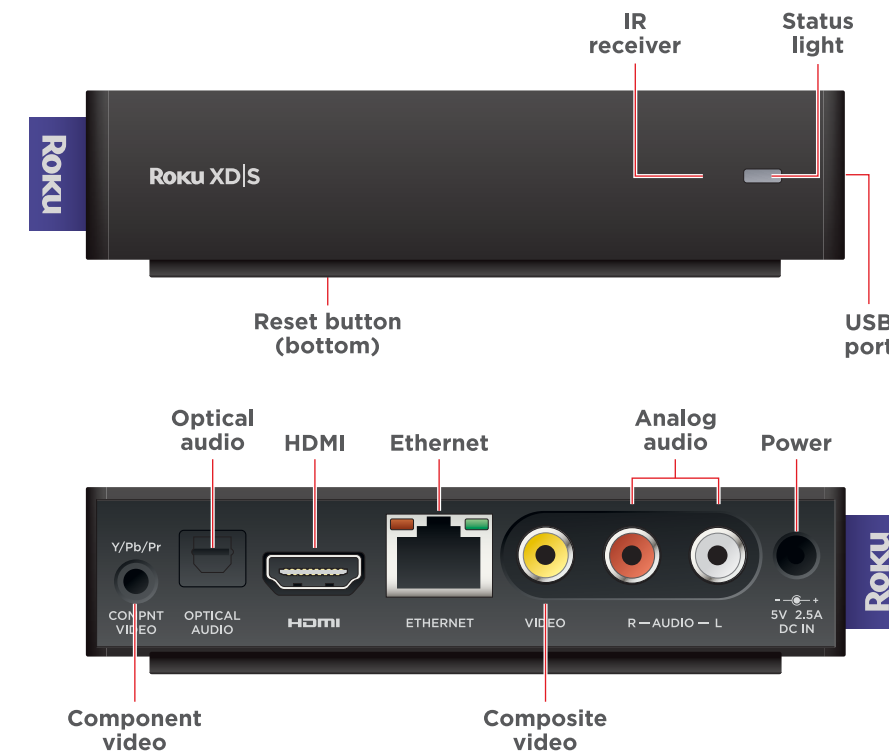

1 | Connect to your TV

Choose the setup that matches the ports on your TV. For best picture quality, use an HDMI connection (if available). Make sure your TV is on and set to display the correct video input.

HDMI (best HD)

Connect an HDMI cable* to the **HDMI** port on your player and to the **HDMI IN** port on your TV.



Component (HD)

Connect a component to 3.5mm cable** to the **COMPNT CABLE** port on your player and the **COMPONENT IN** port on your TV. Connect the red and white connectors on the red/yellow/white RCA cable to the **R-AUDIO-L** ports on your player and the **L/R AUDIO IN** ports on your TV.

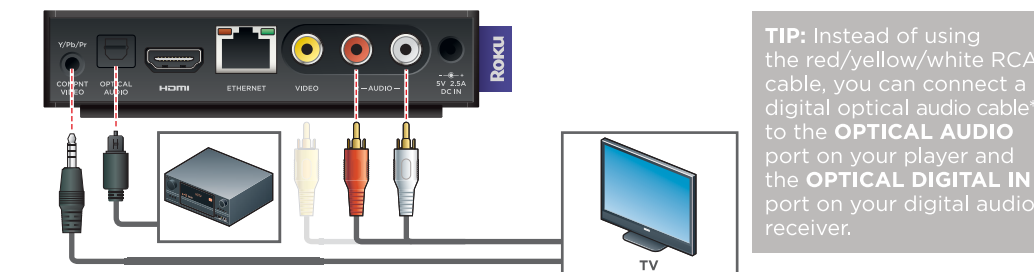

RCA

Connect the yellow connectors on the red/yellow/white RCA cable to the **VIDEO** port on your player and the **VIDEO IN** port on your TV. Connect the red and white connectors to the **R-AUDIO-L** ports on your player and the **L/R AUDIO IN** ports on your TV.

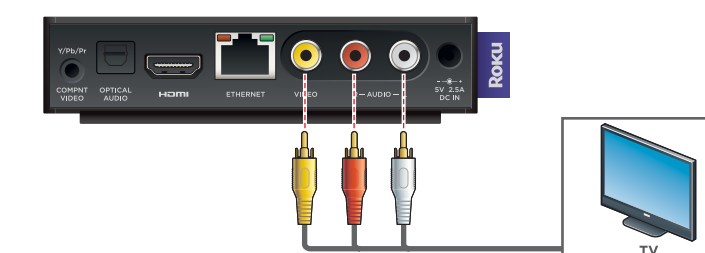

* sold separately
** sold separately only at www.roku.com

2 | Power up

Insert the batteries in the remote

Slide the bottom half of the remote downward to open the remote. Insert two AAA batteries (included) in your remote.



Connect the power adapter to your player



Continued >

3 | Connect to your network

To use your player, you must connect it to your home network. Typically, customers connect to a wireless (or wired) router rather than directly to a broadband modem. Choose Wireless or Wired setup below, then follow the Guided Setup on-screen to complete the connection process.

IMPORTANT: Don't place anything on top of your Roku player. Placing objects on top of your player may interfere with the wireless signal, or cause the player to overheat.

Wireless

Place your player within range of your wireless network. Avoid enclosing your player in a cabinet. During Guided Setup, you may need to enter a password if your network has security turned on.

TIP: During Guided Setup, look for the signal strength bars above your network name. If you don't receive a strong signal, try rotating or moving your player — even a few inches can help.



or

Wired

Use an Ethernet cable (not included) to connect your player to your router.



4 | Complete Guided Setup

On your TV

- Use the remote to follow the on-screen instructions. Your player may download software updates or restart during setup.
- When Guided Setup prompts you to enter your Roku linking code, use your computer to go to roku.com/link. Enter the code that appears on your TV screen and then create a Roku account, if you do not already have one.
- Once you complete setup, select a channel icon (such as Netflix or Amazon Video On Demand) to view, or visit the Roku Channel Store to add more channels (such as the Pandora Internet radio channel).
- Some Roku channels may require you to activate your Roku player to access their content. Just follow the on-screen instructions when you launch a channel for the first time.



TIP: Point your remote directly at your player.

5 | Basic remote functions

To do this	Press this
Move left or right	← or →
Move up or down	↑ or ↓
Scroll left one page at a time	⏪
Scroll right one page at a time	⏩
Select an option from a menu	OK
Return to previous screen	← or ↑ (from top of screen)
Return to Roku home screen	🏠
Start or pause playback	▶
Exit playback	← or ↑
Fast forward	⏩
Rewind	⏪
View more options	*
Replay last 7 seconds of video	↺

Need help?



To view frequently asked questions, watch instructional videos, access user forums, or to contact Roku customer support, go to roku.com/support.

Get started

- 1 Plug in
- 2 Connect
- 3 Watch



ROKU